

**XT
1" Tweeter**



Type Number: XT25TG30-04

Features:

The goal for this tweeter series was to create a transducer that has a frequency response that is flat to above 20K, and where the distortion is far lower than normal and more friendly to the ear. The tweeters represent a unique approach to tweeter design that has resulted in unrivaled performance, as well as in several patents (dual concentric diaphragm, wave-guide center plug).

Driver Highlights: Dual concentric diaphragm (Patent), Wave-guide center plug (Patent), copper-clad aluwire



Specs:

Electrical Data

Nominal impedance	Zn	4	ohm
Minimum impedance	Zmin	--	ohm
Maximum impedance	Zo	19	ohm
DC resistance	Re	2.9	ohm
Voice coil inductance	Le	--	mH

T-S Parameters

Resonance Frequency	fs	530	Hz
Mechanical Q factor	Qms	--	
Electrical Q factor	Qes	--	
Total Q factor	Qts	--	
Force factor	Bl	2.5	Tm
Mechanical resistance	Rms	0.38	Kg/s
Moving mass	Mms	0.3	g
Suspension compliance	Cms	--	mm/N
Effective cone diameter	D	--	cm
Effective piston area	Sd	5.4	cm ²
Equivalent volume	Vas	--	ltrs
Sensitivity		91.1	dB

Power handling

Long-term Max System Power (IEC)	--	W
Short Term Max power	--	W

Voice Coil and Magnet Parameters

Voice coil diameter	26	mm
Voice coil height	2.2	mm
Voice coil layers	--	
Height of the gap	2.5	mm
Flux density of gap	--	mWb
Total useful flux	--	mWb
Diameter of magnet	--	mm
Height of magnet	--	mm
Weight of magnet	--	Kg

Frequency:

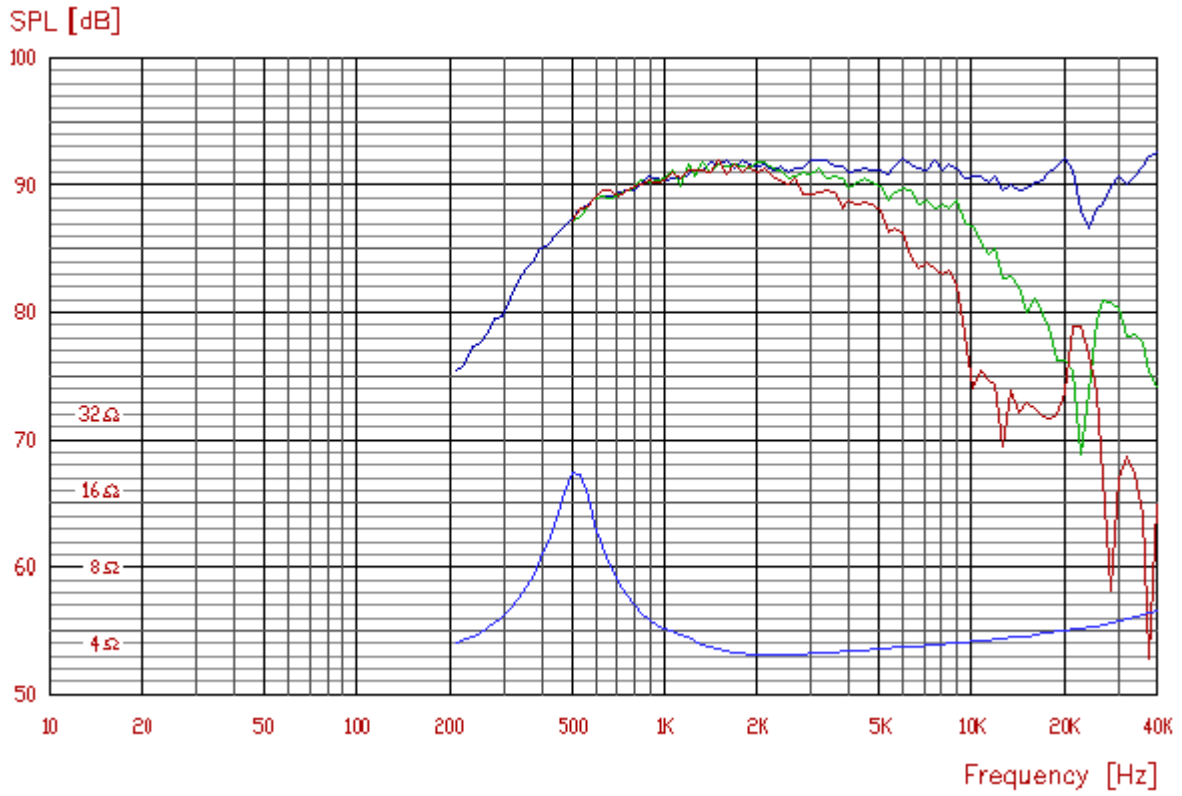

Mechanical Dimensions:

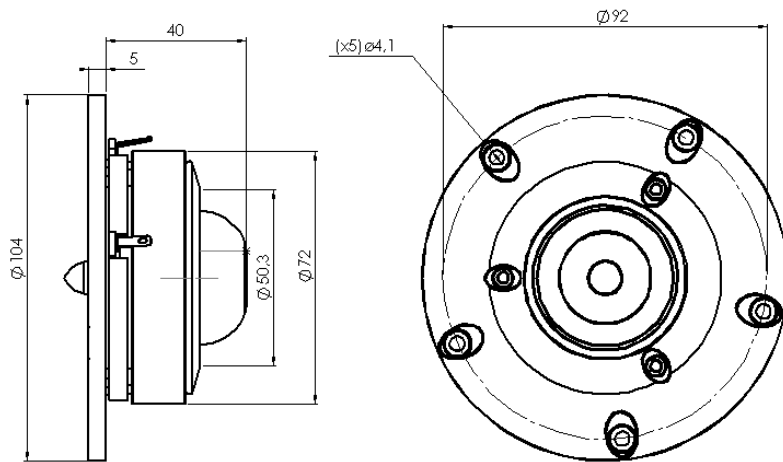

XT25TG30-04