



TG/TC 3 1/2" Full Range



Type Number: TG9FSD10-08

Features:

The TG/TC series offers a high performance full range and mid-bass solution for TV products and other compact applications. Extensive development work by the Peerless audio engineering team, and the use of leading-edge technologies like polymer-chassis, NRSC (Tymphany patent) Glass Fibre or Paper Cone and CU-cap on pole piece, have made this full range driver appear on many industry insider lists as the best sounding solution in this market.

Driver Highlights: 3 1/2" fullrange, polymer-chassis, glass fibre cone, NRSC cone, CU-cap on pole, magnetically shielded



Specs:

Electrical Data

Nominal impedance	Zn	8	ohm
Minimum impedance	Zmin	--	ohm
Maximum impedance	Zo	--	ohm
DC resistance	Re	6.3	ohm
Voice coil inductance	Le	0.12	mH
Capacitor in series with x ohm	Cc	--	uF

T-S Parameters

Resonance Frequency	fs	87	Hz
Mechanical Q factor	Qms	3.08	
Electrical Q factor	Qes	0.87	
Total Q factor	Qts	0.68	
Force factor	Bl	2.95	Tm
Mechanical resistance	Rms	--	Kg/s
Moving mass	Mms	2.2	g
Suspension compliance	Cms	--	mm/N
Effective cone diameter	D	--	cm
Effective piston area	Sd	38	cm ²
Equivalent volume	Vas	3.1	ltrs
Sensitivity (2.83V/1m)		82.5	dB
Sensitivity (1W/1m)		--	dB
Ratio BL/√(Re)		--	
Ratio fs/Qts	F	--	

Frequency:

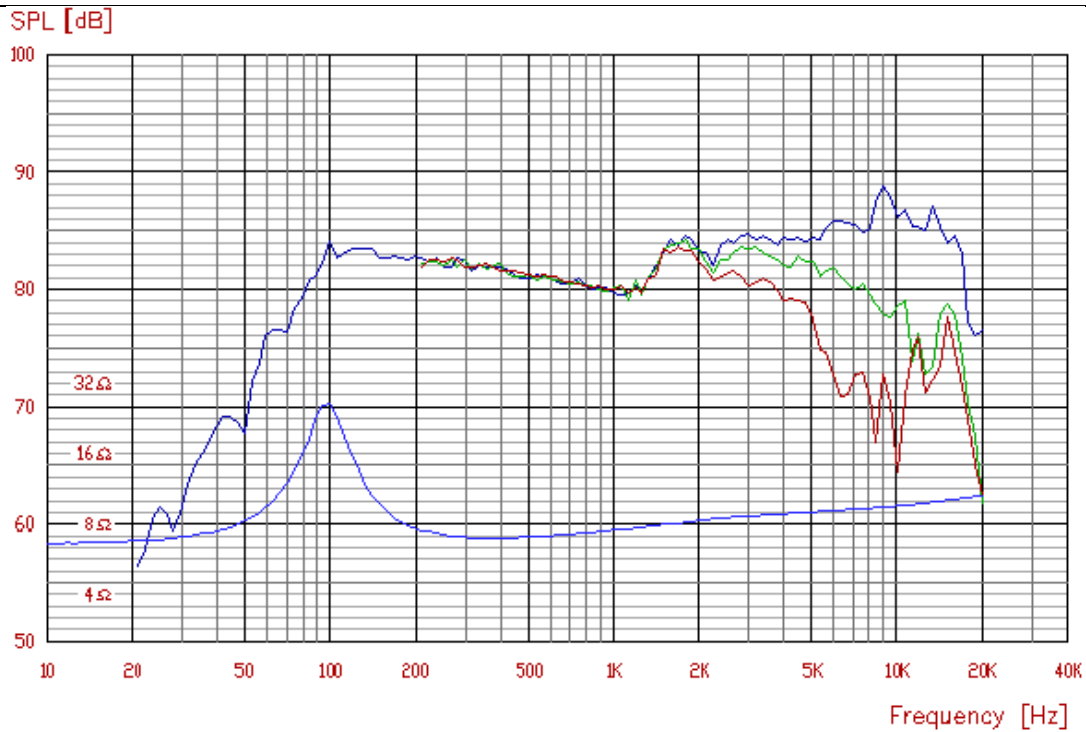

Mechanical Dimensions:

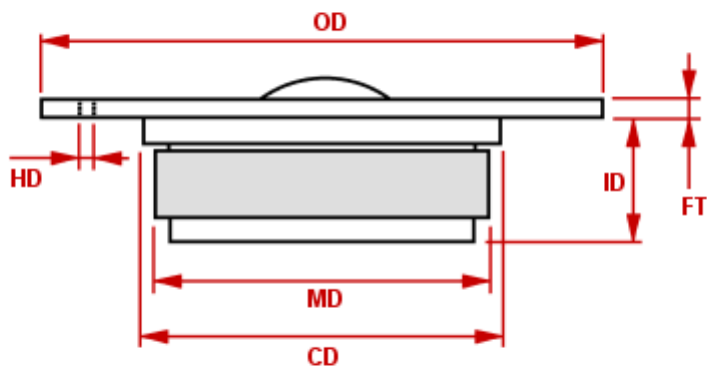

Drawing Dimensions

Outside Diameter	OD	--
Flange Thickness	FT	3.2
Magnet Diameter	MD	68
Cutout Diameter	CD	78.5
Interior Depth	ID	38
Hole Diameter	HD	4.2
Screw Circle Diameter	SD	--